

RoHS

This products can apply to the SWB Doc NO. QA-3-04-005 of Environmental&Material Management Rules

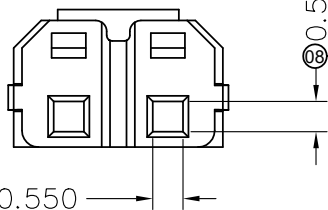
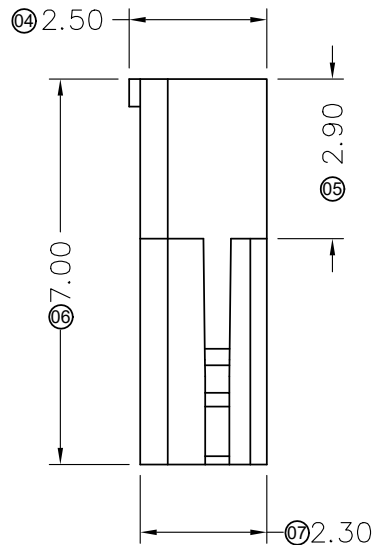
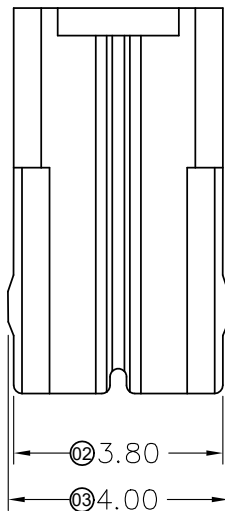
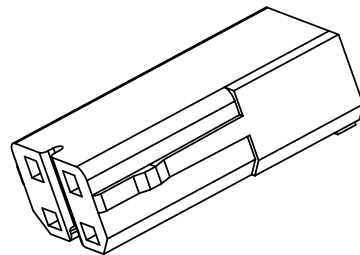
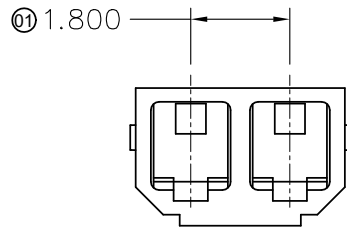

■ Specifications :

- Voltage rating: 350V AC / DC
- Current rating: 3.2A AC / DC
- Withstanding voltage: 1700V AC/minute
- Temperature range: -40°C~+105°C
- Insulation resistance: ≥1000MΩ
- Contact resistance: ≤10mΩ
- After environmental testing: ≤20mΩ
- Suitable SWB Terminal: 1800TX-PSN-A
- Suitable SWB Wafer: 1800WRS-02

1800 H X-02 XX-N0 HF
 ① ② ③ ④ ⑤ ⑥ ⑦

- ① Series No.
- ② Category: H-HSG
- ③ Welding Board Angle: Blank-ordinary
- ④ Row No.-Pin No.: 02-02P
- ⑤ Special No.:
- ⑥ Material: N0-PA66 94V-0
- ⑦ HF-Halogen Free

					东莞市思索连接器有限公司 SWB CONNECTORS CO.,LTD				PART NO. 1800H-02-N0HF				
Update Drawing Frame, The Same ECR And ECN NO					APPROVAL				TITLE 1.80mm Crimp Style Connectors				
Drawing finish					CHECK				SHEET				
DESCRIPTION					DRAWN				REV				
MODIFY					DATE				NUMBER				
PROJECT					Smark				A-022				
GENERAL TOLERANCE					.X ±0.30				UNIT mm				
.XX ±0.20					.XXX ±0.10				SCALE 1:1				
X.° ±2°					Guo				SHEET 1/1				
DATE					Yu wei				REV C				
EN20200317003					Yu wei				NUMBER				
EN20171121001					2017/04/07				A-022				

RoHS

This products can apply to the SWB Doc NO. QA-3-04-005 of Environmental&Material Management Rules

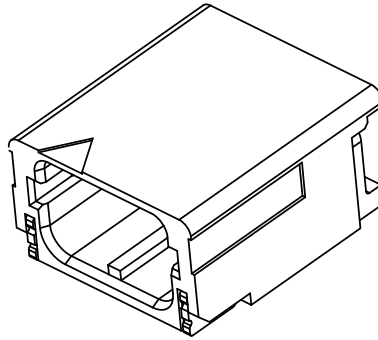
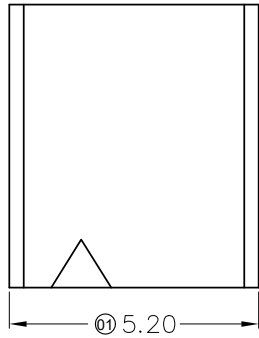

■ Specifications :

- Voltage rating: 350V AC / DC
- Current rating: 3.2A AC / DC
- Withstanding voltage: 1700V AC/minute
- Temperature range: -40°C~+105°C
- Insulation resistance: ≥1000MΩ
- Contact resistance: ≤10mΩ
- After environmental testing: ≤20mΩ

- Material(Pin&Solder tab):Brass
- Mates With SWB Housing:1800H-02

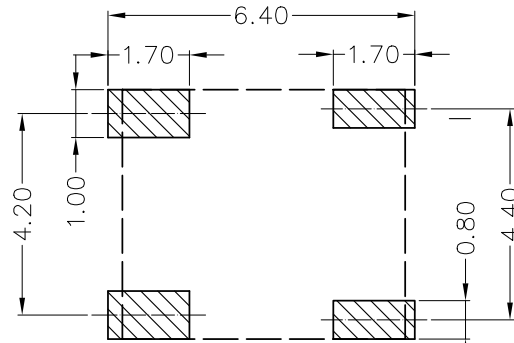
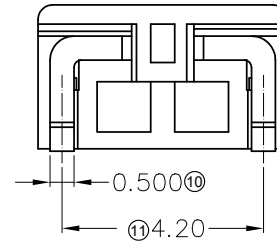
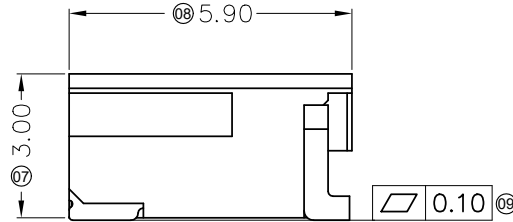
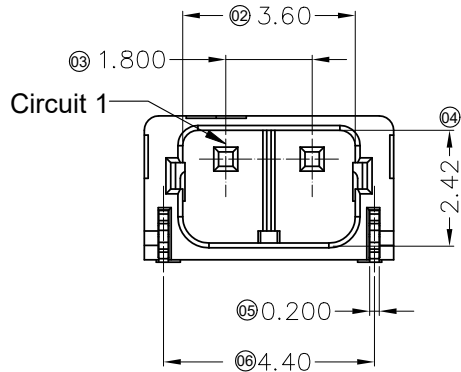

Recommended P.C.B Layout
General Tolerance±0.05

1800 W R S-02 X -LP SW XX
① ② ③ ④ ⑤ ⑥ ⑦ ⑧ ⑨

- ① Series No.
- ② Category: W-WAFER
- ③ Connector Type: R-Right Angle 90°
- ④ Mounting Type.: S-SMT
- ⑤ Row No.-Pin No.: 02-02P
- ⑥ Special No.: Blank-Without Lock
- ⑦ Material: LP -LCP 94V-0
- ⑧ Plating Category:
SW- 50u"Min Ni 、 100u"Min Matte Tin
- ⑨ Color : Blank-Natural Color



					<p>GENERAL TOLERANCE</p> <p>.X ±0.30</p> <p>.XX ±0.20</p> <p>.XXX ±0.10</p> <p>X.° ±2°</p>				<p>东莞市思索连接器有限公司</p> <p>SWB CONNECTORS CO.,LTD</p>				<p>PART NO.</p> <p>1800WRS-02-LPSW</p>								
					<p>APPROVAL</p> <p>Smak</p>				<p>CHECK</p> <p>Guo</p>				<p>DRAWN</p> <p>Alan qin</p>				<p>DATE</p> <p>2017/01/19</p>				
					<p>PROJECT</p>												<p>TITLE</p> <p>1.80mm Crimp Style Connectors</p>				
																	<p>UNIT</p> <p>mm</p>				
																	<p>SCALE</p> <p>1:1</p>				
																	<p>SHEET</p> <p>1/1</p>				
																	<p>REV</p> <p>C</p>				
																	<p>NUMBER</p> <p>A-000</p>				

2020/03/17	C	EN20200317003	Update Drawing Frame, The Same ECR And ECN NO	Zeng	Robing
2017/11/21	B	EN20171121001	Drawing finish	Yu wei	Jacky
DATE	REV	ECN NO.	DESCRIPTION	MODIFY	APPROVAL