

RoHS

This products can apply to the SWB Doc NO. QA-3-04-005 of Environmental&Material Management Rules

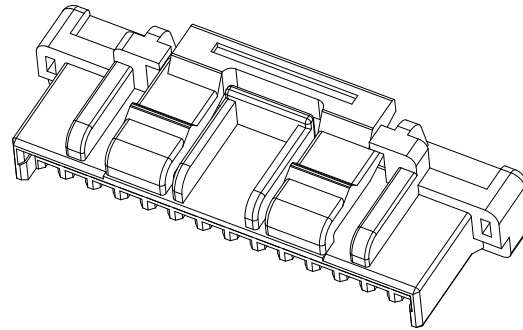
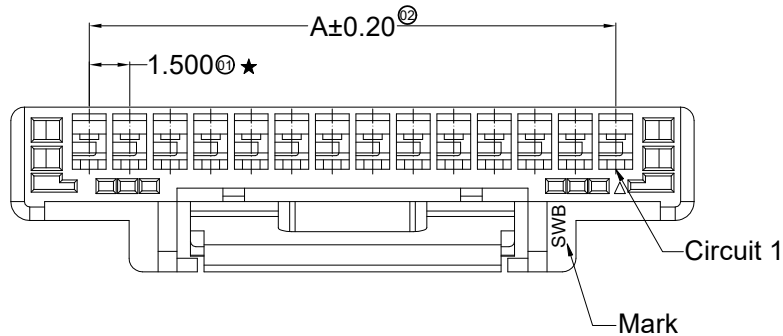

■ Specifications :

- Voltage rating: 100V AC / DC
- Current rating: 2A AC / DC
- Withstanding voltage: 500V AC/minute
- Temperature range: -40°C~+105°C
- Insulation resistance:≥500MΩ
- Contact resistance: ≤20mΩ
- After environmental testing: ≤40mΩ
- Suitable SWB Terminal:1515T
- Mates With SWB Wafer:1515W
- "★" Critical dimension

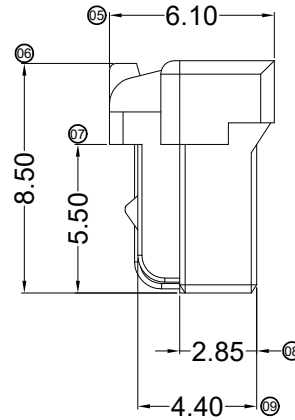
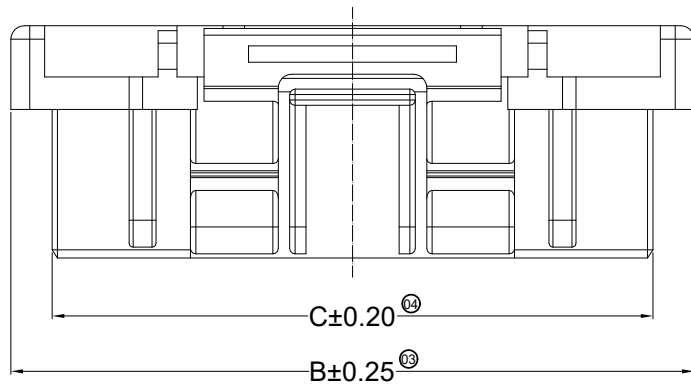

1515 H X-XX X-XX XX XX
① ② ③ ④ ⑤ ⑥ ⑦ ⑧

- ① Series No.
- ② Category: H-HSG
- ③ Appearance type: Blank-ordinary
- ④ Row No.-Pin No.: XX-02P~15P
- ⑤ Special No.: Blank-Ordinary
- ⑥ Material: N0-PA66 94V-0
- ⑦ Color: Blank-Natural Color
- ⑧ HF-Halogen Free

02P~03P Shape Scale 1:1

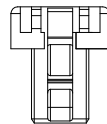
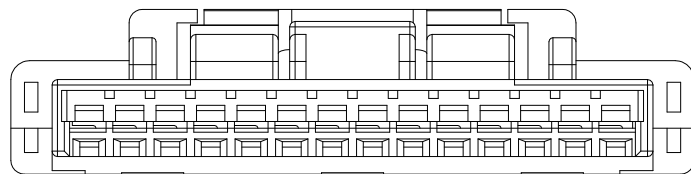

02P~03P Shape Scale 1:2

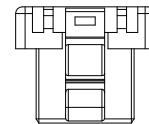

04P~05P Shape Scale 1:2

Poles	Dimensions (mm)			Poles	Dimensions (mm)		
	A	B	C		A	B	C
02	1.50	7.30	4.25	09	12.00	17.80	14.75
03	3.00	8.80	5.75	10	13.50	19.30	16.25
04	4.50	10.30	7.25	11	15.00	20.80	17.75
05	6.00	11.80	8.75	12	16.50	22.30	19.25
06	7.50	13.30	10.25	13	18.00	23.80	20.75
07	9.00	14.80	11.75	14	19.50	25.30	22.25
08	10.50	16.30	13.25	15	21.00	26.80	23.75

							GENERAL TOLERANCE		东莞市思索连接器有限公司 SWB CONNECTORS CO.,LTD				PART NO. 1515H-XX-N0XX				
							X	±0.30					TITLE 1.50mm Crimp Style Connectors				
2019/07/10	A	B	EN20190710002	Cancel the PBT material	Hai Li	Robing	.XX	±0.20	APPROVAL	CHECK	DRAWN	DATE					
DATE	OLD REV	NEW REV	ECN	DESCRIPTION	CHECK	APPROVAL	.XXX	±0.10	PROJECT	Robing	Hai Li	Yu wei	2014/06/03	UNIT MM	SCALE 1:1	NUMBER A-000	REV B

RoHS

This products can apply to the SWB Doc NO. QA-3-04-005 of Environmental&Material Management Rules

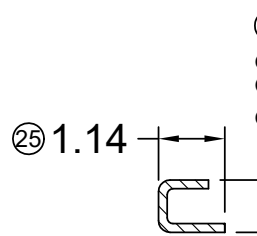
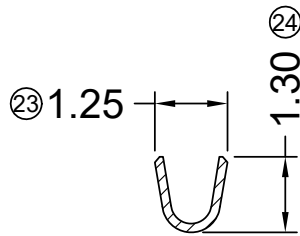
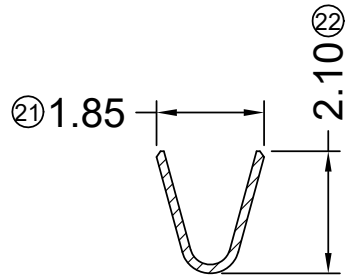
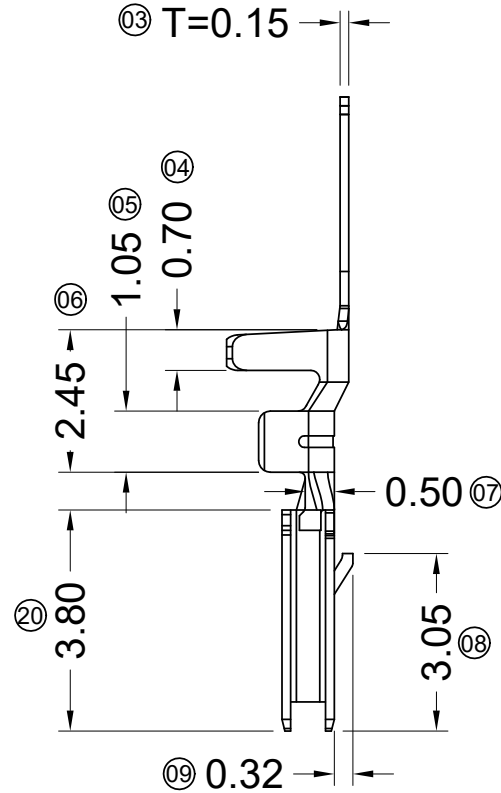
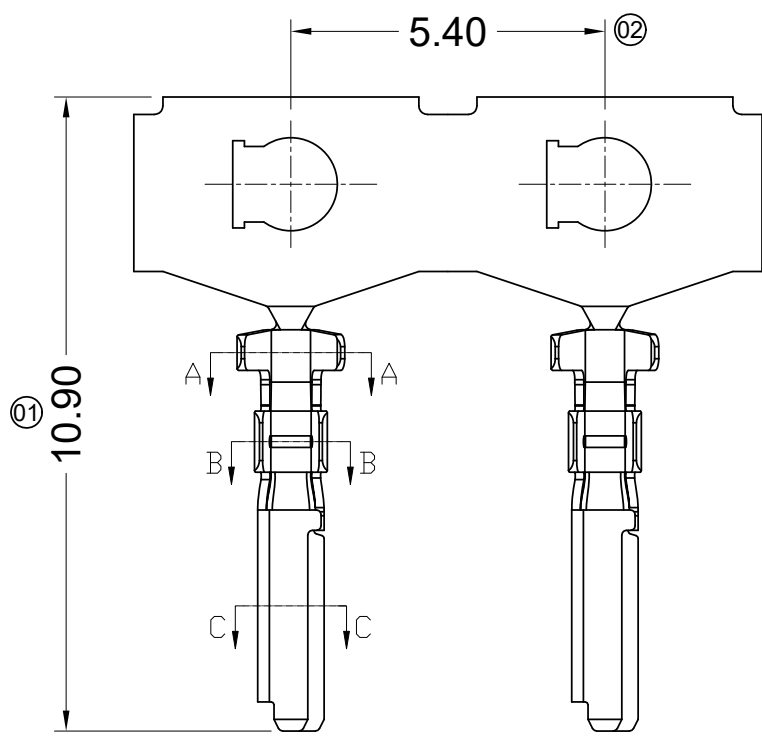

Specifications :

- Voltage rating: 100V AC / DC
- Current rating: 2A AC / DC
- Withstanding voltage: 500V AC/minute
- Temperature range: -40°C~+105°C
- Insulation resistance: ≥500MΩ
- Contact resistance: ≤20mΩ
- After environmental testing: ≤40mΩ
- Material(Pin): Phosphor bronze
- Mates With SWB Housing: 1515H

1515 T X - P SN X - X
 ① ② ③ ④ ⑤ ⑥ ⑦

- ① Series Number
- ② Category: T-terminal
- ③ Shape: Blank-ordinary
- ④ Material: P-Phosphor bronze
- ⑤ Plating code: SN-Bright tin plating
- ⑥ Plating method:
Blank-Stamping before plating
- ⑦ Mold No./Mark/Special No.

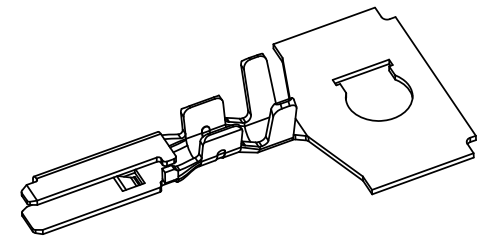

						GENERAL TOLERANCE .X ±0.30 .XX ±0.20 .XXX ±0.10 X.° ±2°				东莞市思索连接器有限公司 SWB CONNECTORS CO.,LTD				PART NO. 1515T-PSN															
						APPROVAL Robing				CHECK YYting				DRAWN Wuxiaotao				DATE 2018/06/05				TITLE 1.50mm Crimp Style Connectors							
2020.3.17	D	EN20200317002	Update Drawing Frame	YYting	Robing	PROJECT				UNIT				SCALE				SHEET				REV				NUMBER			
DATE	REV	ECN NO.	DESCRIPTION	MODIFY	APPROVAL					mm				1:1				1/1				D				A-014			

RoHS

This products can apply to the SWB Doc NO. QA-3-04-005 of Environmental&Material Management Rules

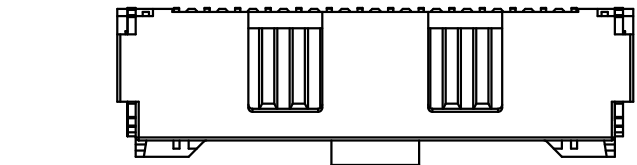

06P-15P Single Hole

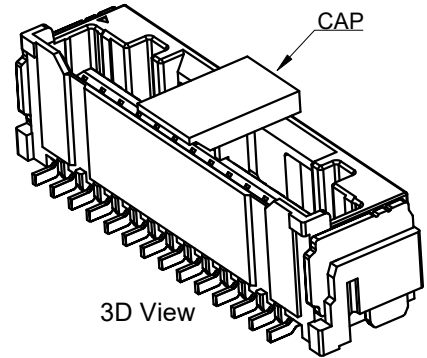
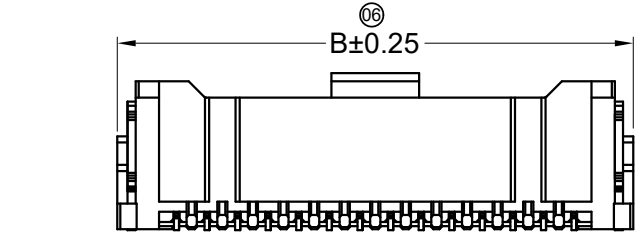
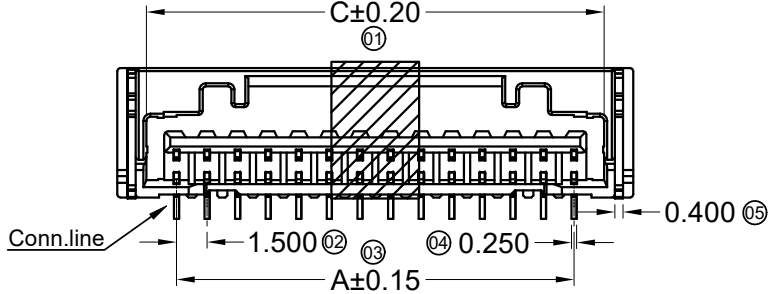

3D View

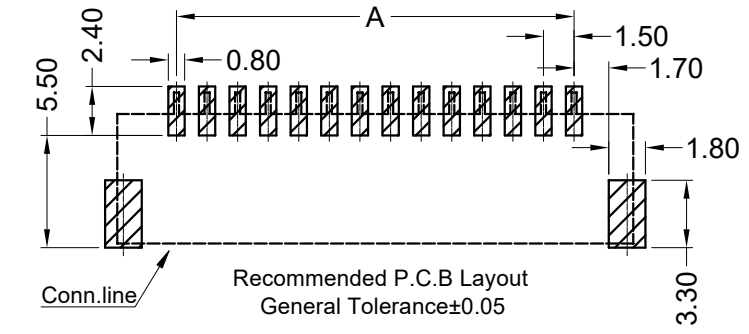

Recommended P.C.B Layout
General Tolerance±0.05

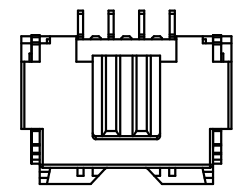
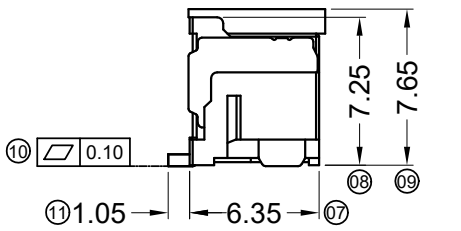

03P-05P Single Hole
Scale 1:1

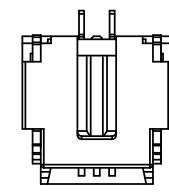

02P Single Hole
Scale 1:1

- Specifications :
- Voltage rating: 100V AC / DC
 - Current rating: 2A AC / DC
 - Withstanding voltage: 500V AC/minute
 - Temperature range: -40°C~+105°C
 - Insulation resistance: ≥500MΩ
 - Contact resistance: ≤20mΩ
 - After environmental testing: ≤40mΩ
 - Material(Pin): Phorphos Bronze
 - Material(Stator): Brass
 - Mates With SWB Housing: 1515H

1515 W V S - XX X - LP SW XX
① ② ③ ④ ⑤ ⑥ ⑦ ⑧ ⑨

- ① Series No.
- ② Category: W-wafer
- ③ Connector type: V- Straight 180°
- ④ Mouting type: S-SMT
- ⑤ Row No.-Pin No per row: XX-02P~15P
- ⑥ Special No.:
- ⑦ Material: LP -LCP 94V-0 ;
- ⑧ Plating Code: SW- Matte Tin Plating
- ⑨ Color: Blank-Natural Color

Poles	Dimensions (mm)			Poles	Dimensions (mm)		
	A	B	C		A	B	C
02	1.50	7.30	4.45	09	12.00	17.80	14.95
03	3.00	8.80	5.95	10	13.50	19.30	16.45
04	4.50	10.30	7.45	11	15.00	20.80	17.95
05	6.00	11.80	8.95	12	16.50	22.30	19.45
06	7.50	13.30	10.45	13	18.00	23.80	20.95
07	9.00	14.80	11.95	14	19.50	25.30	22.45
08	10.50	16.30	13.45	15	21.00	26.80	23.95

						东莞市思索连接器有限公司 SWB CONNECTORS CO.,LTD				PART NO. 1515WVS-XX-LPSW				
						APPROVAL CHECK DRAWN DATE				TITLE 1.50mm Crimp Style Connectors				
						PROJECT 				UNIT SCALE SHEET REV NUMBER mm 1:1 1/2 J A-000				
2021.01.30	J	EN20210130001	Increase The Series Sketch Map	YY'ting	Robing									
2020.03.12	H	EN20200317002	Update Drawing Frame	YY'ting	Robing									
DATE	REV	ECN NO.	DESCRIPTION	MODIFY	APPROVAL									

RoHS

This products can apply to the SWB Doc NO. QA-3-04-005 of Environmental&Material Management Rules

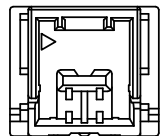

2 PIN

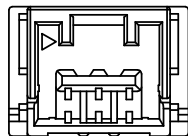

3 PIN

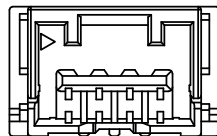

4 PIN

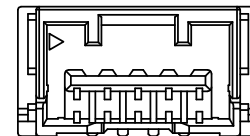

5 PIN

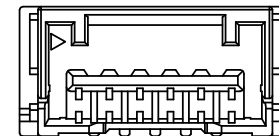

6 PIN

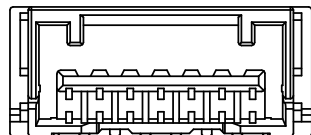

7 PIN

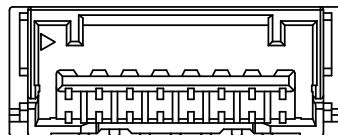

8 PIN

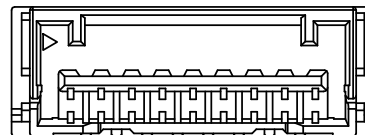

9 PIN

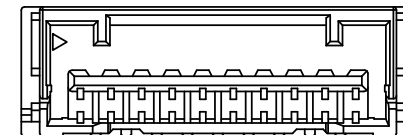

10 PIN

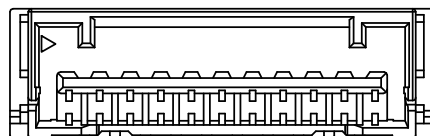

11 PIN

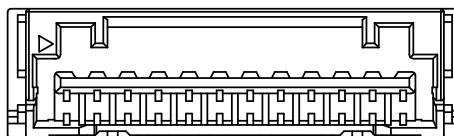

12 PIN

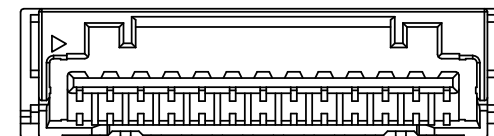

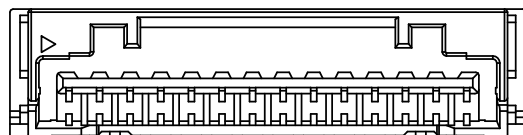

13 PIN

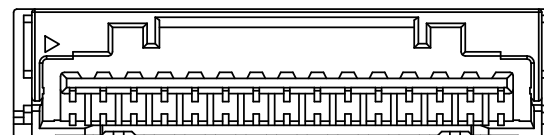

14 PIN



15 PIN

						 东莞市思索连接器有限公司 SWB CONNECTORS CO.,LTD				PART NO. 1515WVS-XX-LPSW				
						APPROVAL CHECK DRAWN DATE				TITLE 1.50mm Crimp Style Connectors				
						PROJECT 				UNIT SCALE SHEET REV NUMBER mm 1:1 2/2 J A-000				
2021.01.30	J	EN20210130001	Increase The Series Sketch Map	YYting	Robing									
2020.03.12	H	EN20200317002	Update Drawing Frame	YYting	Robing									
DATE	REV	ECN NO.	DESCRIPTION	MODIFY	APPROVAL									

1	2		3		4		5		6		7		8	
F														F
E														E
D														D
C														C
B														B
A														A

RoHS

This products can apply to the SWB Doc NO. QA-3-04-005 of Environmental&Material Management Rules



- Specifications :
- Voltage rating: 100V AC / DC
 - Current rating: 2A AC / DC
 - Withstanding voltage: 500V AC/minute
 - Temperature range: -40°C~+105°C
 - Insulation resistance: ≥500MΩ
 - Contact resistance: ≤20mΩ
 - After environmental testing: ≤40mΩ
 - Material(Pin): Phorphos Bronze
 - Material(Stator): Brass
 - Mates With SWB Housing: 1515H-XX

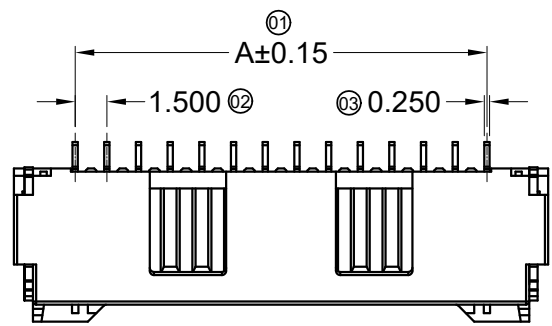

06P-15P Double Hole
Scale 1:1

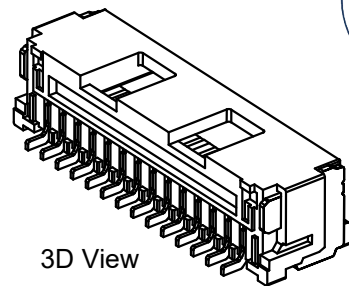

3D View

1515 W R S - XX X - XX SW XX
① ②③④ ⑤ ⑥ ⑦ ⑧ ⑨

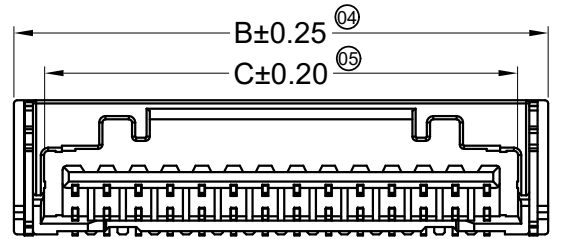

Circuit 1

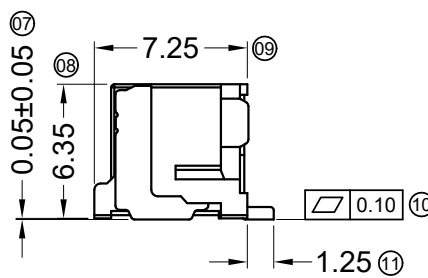

- ① Series No.
- ② Category: W-wafer
- ③ Connector type: R- Right angle 90°
- ④ Mouting type: S-SMT
- ⑤ Row No.-Pin No per row: XX-02P~15P
- ⑥ Special No.:
- ⑦ Material: LP -LCP 94V-0 ;9T-PA9T 94V-0
- ⑧ Planting Code: SW- Matte Tin Plating
- ⑨ Color: Blank-Natural Color;BK-Black

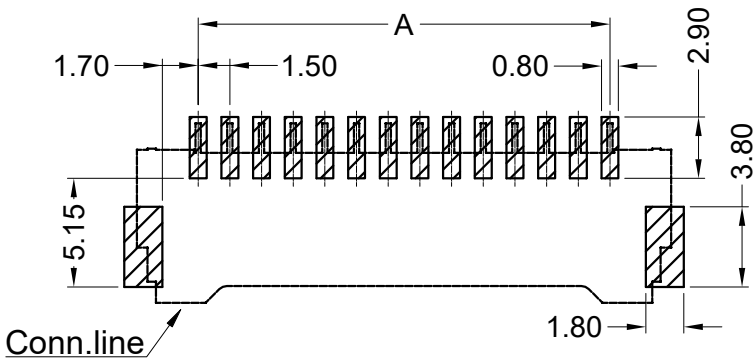

Recommended P.C.B Layout
General Tolerance±0.05

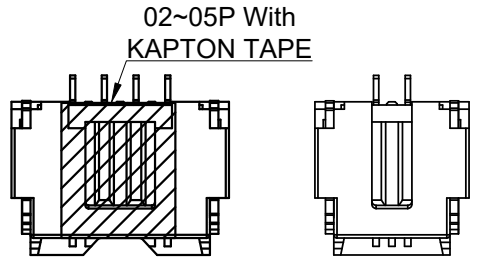

03P-05P Single Hole
Scale 1:1

02P Single Hole
Scale 1:1

Poles	Dimensions (mm)			Poles	Dimensions (mm)		
	A	B	C		A	B	C
02	1.50	7.30	4.45	09	12.00	17.80	14.95
03	3.00	8.80	5.95	10	13.50	19.30	16.45
04	4.50	10.30	7.45	11	15.00	20.80	17.95
05	6.00	11.80	8.95	12	16.50	22.30	19.45
06	7.50	13.30	10.45	13	18.00	23.80	20.95
07	9.00	14.80	11.95	14	19.50	25.30	22.45
08	10.50	16.30	13.45	15	21.00	26.80	23.95

						东莞市思索连接器有限公司 SWB CONNECTORS CO.,LTD				PART NO. 1515WRS-XX-XXSWXX				
						APPROVAL CHECK DRAWN DATE				TITLE 1.50mm Crimp Style Connectors				
						PROJECT 				UNIT SCALE SHEET REV NUMBER mm 1:1 1/2 J A-000				
2021.01.30	J	EN20210130001	Increase The Series Sketch Map	YY'ting	Robing									
2020.03.12	H	EN20180927002	Update Drawing Frame, The Same ECR And ECN NO.	YY'ting	Robing									
DATE	REV	ECN NO.	DESCRIPTION	MODIFY	APPROVAL									

RoHS

This products can apply to the SWB Doc NO. QA-3-04-005 of Environmental&Material Management Rules

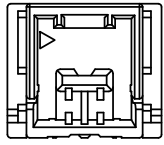

2 PIN

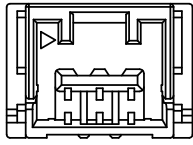

3 PIN

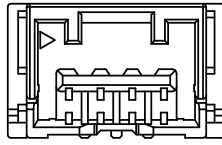

4 PIN

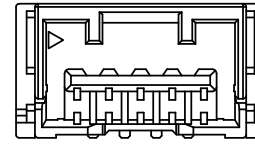

5 PIN

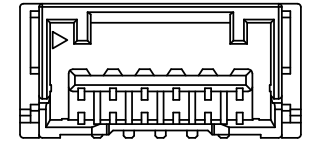

6 PIN

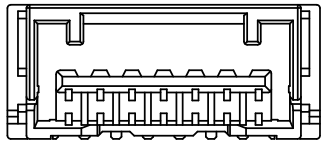

7 PIN

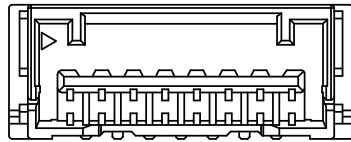

8 PIN

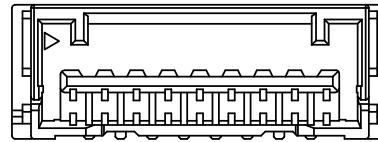

9 PIN

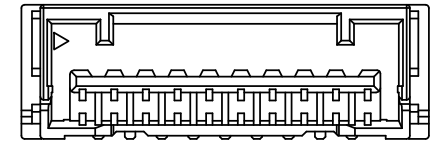

10 PIN

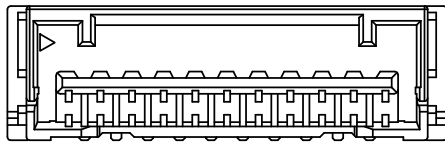

11 PIN

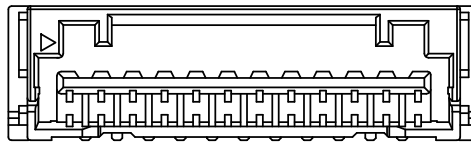

12 PIN

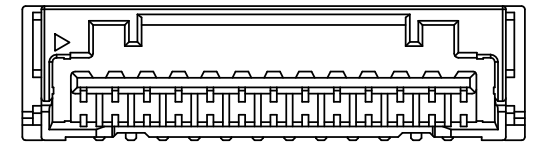

13 PIN

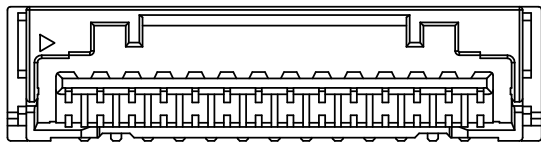

14 PIN

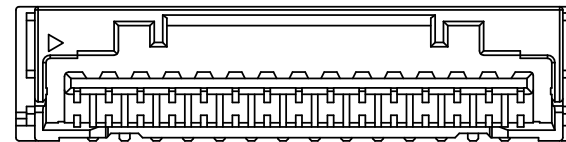

15 PIN

						 东莞市思索连接器有限公司 SWB CONNECTORS CO.,LTD				PART NO. 1515WRS-XX-XXSWXX														
2021.01.30 J EN20210130001 Increase The Series Sketch Map YY'ting Robing						GENERAL TOLERANCE .X ±0.30 .XX ±0.20 .XXX ±0.10 X.° ±2°				TITLE 1.50mm Crimp Style Connectors														
2020.03.12 H EN20180927002 Update Drawing Frame, The Same ECR And ECN NO. YY'ting Robing						APPROVAL CHECK DRAWN DATE Robing YYting YYting 2020.3.12				<table border="1"> <tr> <th>UNIT</th> <th>SCALE</th> <th>SHEET</th> <th>REV</th> <th>NUMBER</th> </tr> <tr> <td>mm</td> <td>1:1</td> <td>2/2</td> <td>J</td> <td>A-000</td> </tr> </table>					UNIT	SCALE	SHEET	REV	NUMBER	mm	1:1	2/2	J	A-000
UNIT	SCALE	SHEET	REV	NUMBER																				
mm	1:1	2/2	J	A-000																				
DATE	REV	ECN NO.	DESCRIPTION	MODIFY	APPROVAL	PROJECT																		